



TECHMAN ROBOT

TECHMAN ROBOT

A leading company in collaborative robot and vision technologies.

The color settings in color classifier can be reattach individually.

Outline

- Purpose

The color settings in color classifier of AOI function can be reattach or rename individually.

- Equipment

TM5 / TM12 /TM14

- Function operation

Function operation(1/4)

The color classifier which has been taught will show up in the list of color

Identify

Color Classifier

Image Source
Contrast_1

Name
Color_1

Reset Color Area

Restart Training Process

List of Colors:

- Color_1
- Blue
- pink

The color classifier has been taught

Live Video

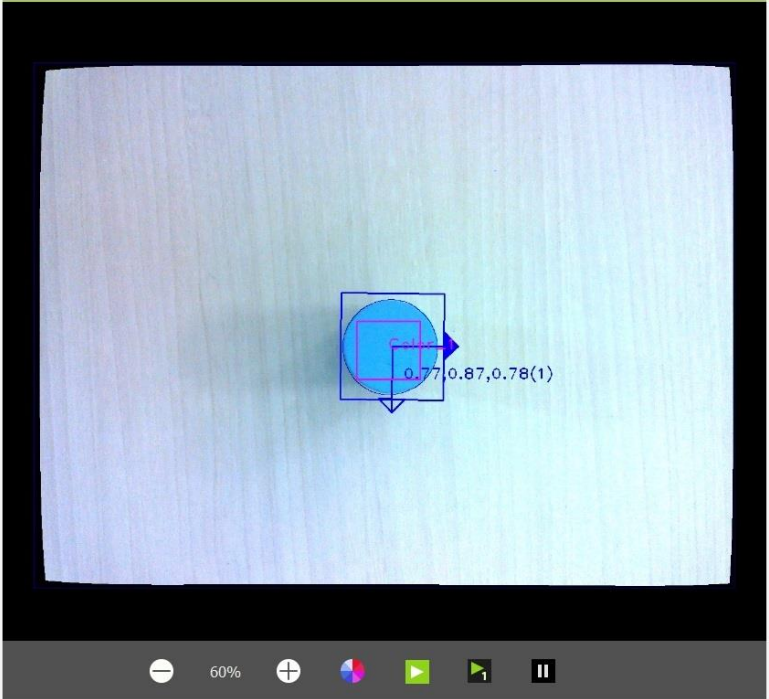

Function operation(2/4)

If you want to reattach the color
Step 1. Select the color you
want to change.

Step 2. Click “yes” on the
pop-up window.

Identify

Color Classifier

Image Source
Contrast_1

Name
Color_1

Reset Color Area

Restart Training Process

List of Colors:

- 1. Color_1
- Blue
- pink

Live Video

Warning

Would you like to re-train this color?

2. Yes Cancel

Function operation(3/4)

Step 3. After step 2, another pop-up windows will show the name of this color classifier.
Step 4. Modify the name of this color classifier.

3. The Original name

Name of the 1st Color

Please place the object with this color, and then press Next

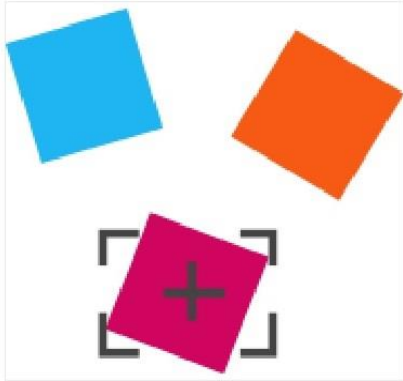

Next Cancel

4. The new name

Name of the 1st Color

Please place the object with this color, and then press Next

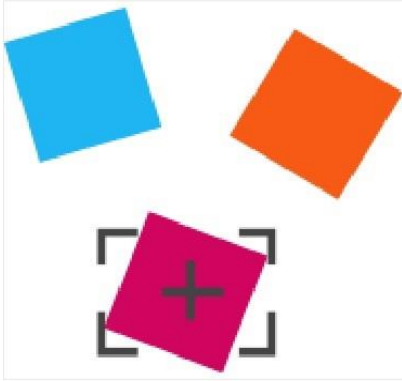

Next Cancel

Function operation(4/4)

Step 5. the color name in live view will be changed immediately when modifying the name. And click "Next" to exit.

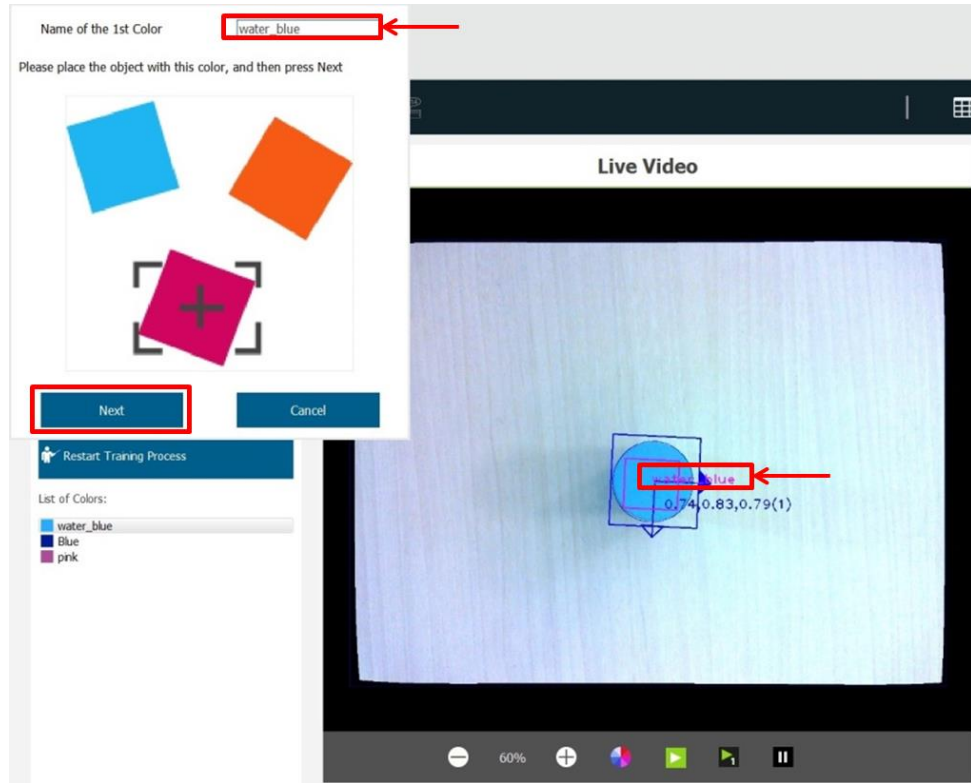



TECHMAN
ROBOT

THANK YOU