



# Posture Setting

# Introduction

## ➤ Purpose

### Posture Setting–

TM robot has recorded three commonly used posture (Packing. Normal. Home)in posture setting. User can move to these posture without enter the degree of joints manually.

## ➤ Device

TM5

## ➤ Function Demonstration

- (1) Packing Pose
- (2) Normal Pose
- (3) Home Pose

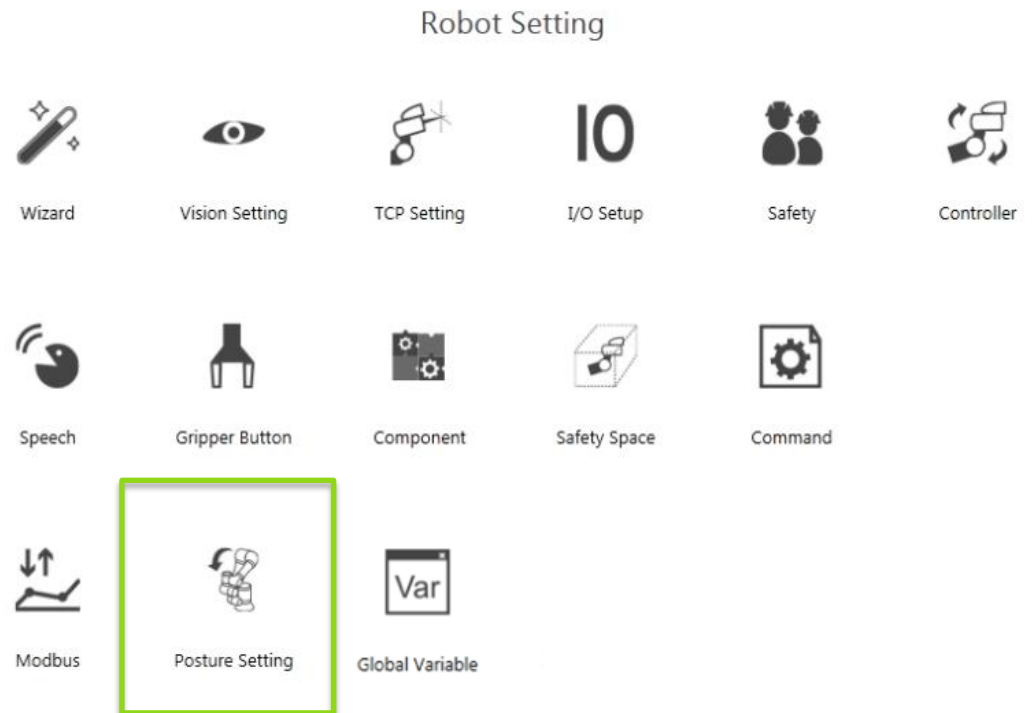



# Posture Setting

Posture Setting

- Click 'Setting' to enter 'Robot Setting'.
- Click 'Posture Setting'.

 Logout

 Connect

 View

 Run Setting

 Project

 Setting

 System

 Shutdown

## Robot Setting



Wizard



Vision Setting



TCP Setting

I/O Setup



Safety



Controller



Speech



Gripper Button



Component



Safety Space



Command



Modbus



Posture Setting



Global Variable



# Packing Pose

Posture Setting

- Packing Pose: Move the robot back into the packing pose as picture below.

## Posture Setting

Packing pose

Normal Pose

Home Pose



Speed 1%

Move (+)

### ⚠ Caution

Please keep distance when you execute the function.

Please continuously press the move (+) or (+) key on Robot Stick to move the Robot back into the packing pose as the following





# Normal Pose

Posture Setting

- Normal: Move the robot back into the normal pose as picture below.

## Posture Setting

Packing pose

Normal Pose

Home Pose

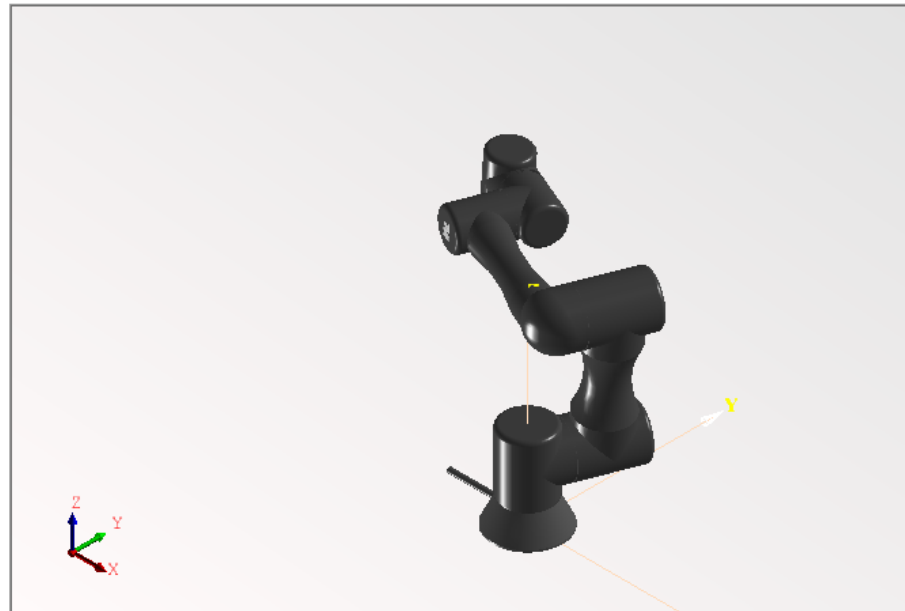

Speed 1%

Move (+)

**Caution**

Please keep distance when you execute the function.

Please continuously press the move (+) or (+) key on Robot Stick to move the Robot back into the normal pose as the following





# Home Pose

Posture Setting

- Home Pose: Move the robot back into home pose as picture below.

## Posture Setting

Packing pose

Normal Pose

Home Pose



Speed 1% ▼

Move (+)

**Caution**

Please keep distance when you execute the function.

Please continuously press the move (+) or (+) key on Robot





# Packing Setting

Posture Setting

- Caution: Please keep distance when executing the function.
- Adjust the speed of robot.
- Continuously press the 'Move(+)' button or (+) on the robot stick to move the robot.

## Posture Setting

Packing pose

Normal Pose

Home Pose

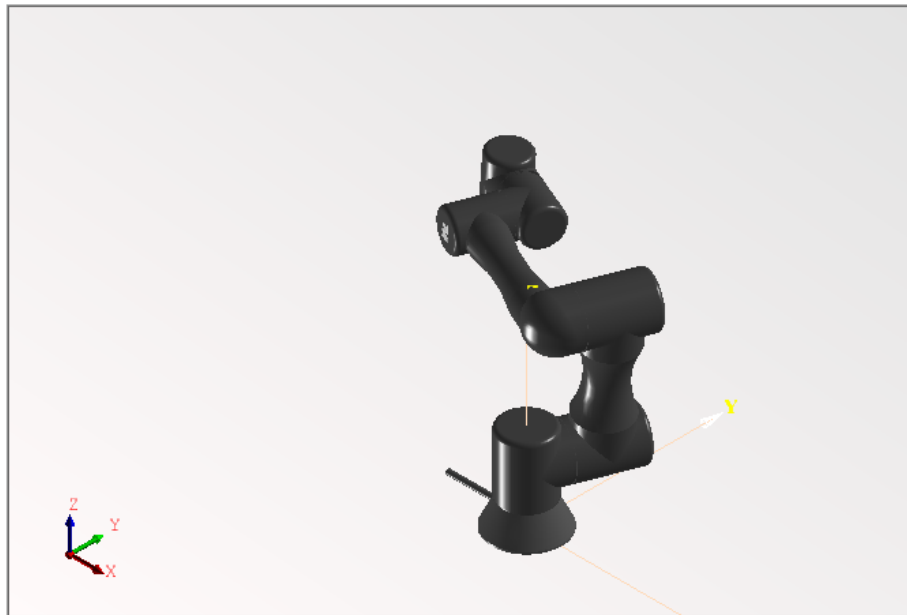

Speed

1%

0.1%

0.5%

1%

5%

Move (+)

**! Caution**

Please keep distance when you execute the function.

Please continuously press the move (+) or (+) key on Robot



END